



CSD-UV18KITS (AM42)

PLC/PLT/PLL Program Start Ballast

Application and Performance Specification

Ballast Type	Electronic	Ballast Factor	High
Starting Method	Program Start	Minimum Starting Temp.	-30°C / -22°F
Lamp Connection	Series	Approvals Class	UL / cUL Listed, Class P UL Type 1 Outdoor
Lamps Operated	1 or 2		
Input Voltage	120-277VAC; 50/60Hz	Warranty	5 Years $t_c \leq 75^\circ\text{C}$ 3 Years $75^\circ\text{C} < t_c \leq 90^\circ\text{C}$
EMI / RFI Compliance	FCC Part 18-A		
Sound Rating	Class A	Safety	Auto-Reset Shutdown Circuit End-of-Life Lamp Protection Surge Protected Type HL No PCBs CAN ICES-005 (A)

Electrical Data

Lamp Type	Lamps Operated	Line Voltage	Input Watts*	Nominal Line Amps	Ballast Factor	Power Factor	THD	Crest Factor
PLC18W PLT18W	2	120	38	0.32	0.90	0.99	10%	1.70
		230		0.17		0.98	15%	
		277		0.13		0.98	15%	
	1	120	22	0.18	1.10	0.98	15%	
		230		0.09		0.97	15%	
		277		0.08		0.96	20%	
PLC13W PLT13W	2	120	35	0.29	1.80	0.99	10%	1.70
		230		0.16		0.98	15%	
		277		0.12		0.97	20%	
	1	120	19	0.18	1.22	0.98	15%	
		230		0.08		0.97	20%	
		277		0.06		0.95	25%	
PLL13W	2	120	29	0.24	0.99	0.99	10%	1.70
		230		0.12		0.98	15%	
		277		0.10		0.97	20%	
	1	120	17	0.18	1.15	0.98	15%	
		230		0.07		0.97	20%	
		277		0.06		0.95	25%	
2D16W	2	120	38	0.31	0.92	0.99	10%	1.70



© All documentation is subject to change without notice. Please refer to our website for the latest product information and specifications. Please contact us for details.

www.lumenefficientdesign.ca



CSD-UV18KITS (AM42)

PLC/PLT/PLL Program Start Ballast

Electrical Data

Lamp Type	Lamps Operated	Line Voltage	Input Watts*	Nominal Line Amps	Ballast Factor	Power Factor	THD	Crest Factor
	1	230	21	0.17	0.98	0.98	15%	
		277		0.13		0.97	15%	
		120		0.18		0.98	15%	
		230		0.09		0.97	15%	
		277		0.08		0.96	25%	
PLC26W	1	120	29	0.24	1.10	0.98	15%	1.70
PLT26W		230		0.13		0.98	15%	
		277		0.10		0.96	15%	
2D28W	1	120	29	0.25	0.75	0.98	15%	1.70
		230		0.13		0.98	15%	
		277		0.10		0.96	15%	
2D21W	1	120	20	0.17	0.77	0.98	15%	1.70
		230		0.09		0.97	20%	
		277		0.07		0.96	25%	
FC9T5	1	120	22	0.18	0.82	0.98	15%	1.70
		230		0.09		0.97	20%	
		277		0.08		0.96	25%	
FC8T5	1	120	16	0.13	0.58	0.98	15%	1.70
		230		0.07		0.97	20%	
		277		0.06		0.96	25%	

* ANSI measured wattage; 25°C ambient; bench top; lamps base up
 Application and Performance Specification Information is subject to change without notification.

Wiring Diagram

Mechanical Data

Wiring Diagram			Mechanical Data		
Lead Length (Kit)			Overall Length (L)	4.92"	12.50 cm
Black	9.00"	23.00 cm	Width (W)	2.51"	6.40 cm
White	9.00"	23.00 cm	Height (H)	1.14"	2.90 cm
Green	9.00"	23.00 cm	Mounting (M)	4.49"	11.40 cm
Red	9.00"	23.00 cm	Case Quantity	20	
Blue	9.00"	23.00 cm	Net Weight	15.65 lbs	7.10 kg
Yellow	9.00"	23.00 cm	Gross Weight	17.86 lbs	8.10 kg



© All documentation is subject to change without notice. Please refer to our website for the latest product information and specifications. Please contact us for details.

www.lumenefficientdesign.ca

CSD-UV18KITS (AM42)

PLC/PLT/PLL Program Start Ballast

Wiring Diagram

Mechanical Data

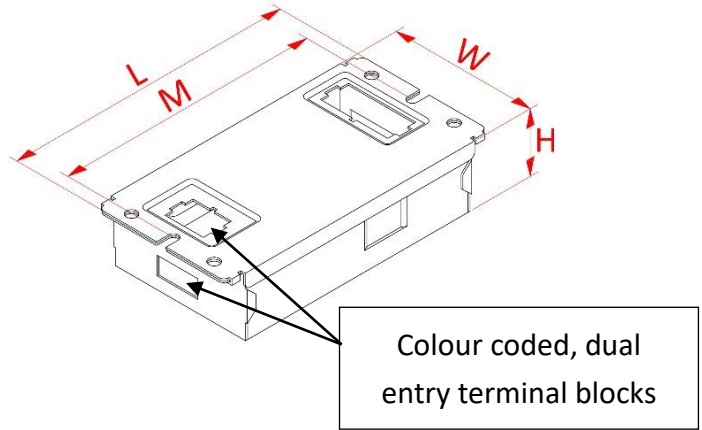
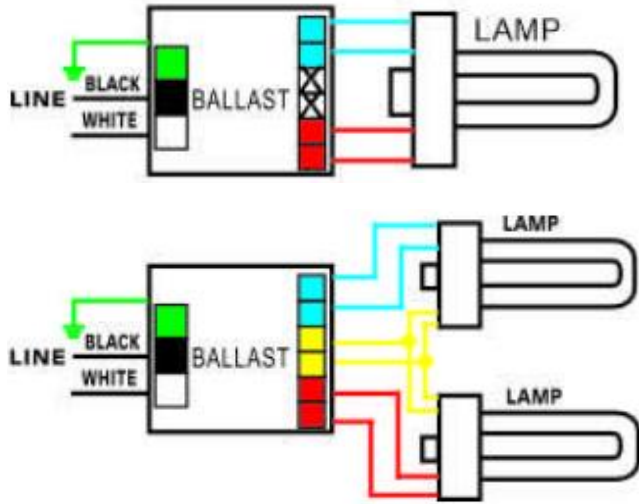

Mounting Plate with Studs

Extending Wire Set

Wire Extraction Tool

Hardware

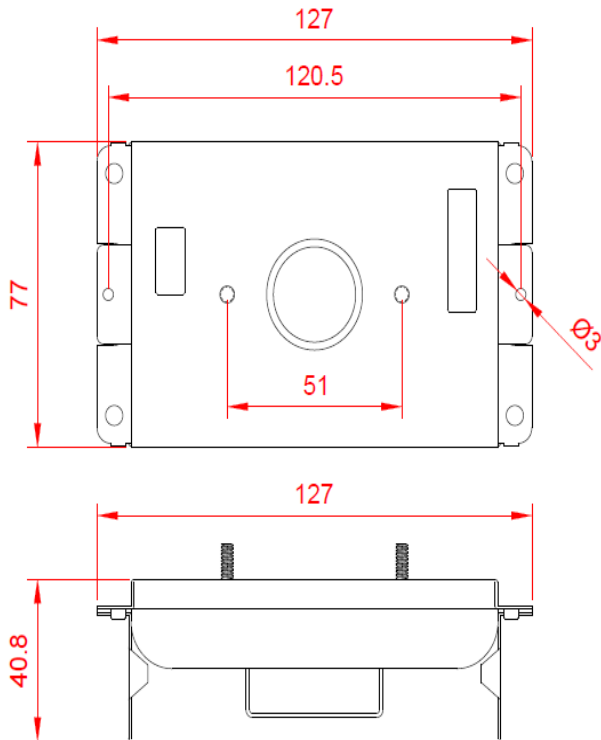

Maximum wiring distance (at full load) is 18AWG/18'
Ballast must be grounded

Install in accordance with the National Electrical Code

