



# CSS-UV42KITS (AM42)

# PLC/PLT/PLL Program Start Ballast Kit

## Application and Performance Specification

Ballast Type	Electronic	Ballast Factor	High
Starting Method	Program Start	Minimum Starting Temp.	-30°C / -22°F
Lamp Connection	Series	Approvals Class	UL / cUL Listed, Class P UL Type 1 Outdoor
Lamps Operated	1 or 2		
Input Voltage	120-277VAC; 50/60Hz	Warranty	5 Years $t_c \leq 75^\circ\text{C}$ 3 Years $75^\circ\text{C} < t_c \leq 90^\circ\text{C}$
EMI / RFI Compliance	FCC Part 18-A		
Sound Rating	Class A	Safety	Auto-Reset Shutdown Circuit End-of-Life Lamp Protection Surge Protected Type HL No PCBs CAN ICES-005 (A)

## Electrical Data

Lamp Type	Lamps Operated	Line Voltage	Input Watts*	Nominal Line Amps	Ballast Factor	Power Factor	THD	Crest Factor
PLC26W PLT26W	2	120	53	0.46	0.86	0.99	10%	1.70
		230		0.22		0.98	15%	
		277		0.18		0.97	20%	
	1	120	30	0.23	0.88	0.99	15%	
		230		0.12		0.97	15%	
		277		0.11		0.95	20%	
PLL27W	2	120	46	0.38	0.83	0.99	10%	1.70
		230		0.20		0.98	15%	
		277		0.17		0.97	20%	
	1	120	26	0.21	0.80	0.99	15%	
		230		0.12		0.97	20%	
		277		0.10		0.95	20%	
PLC26W PLT26W	1	120	29	0.24	1.10	0.98	15%	1.70
		230		0.13		0.98	15%	
		277		0.10		0.96	15%	
2D21W	2	120	44	0.37	0.81	0.99	15%	1.70
		230		0.19		0.98	20%	
		277		0.16		0.97	20%	
PLC42W	1	120	45	0.37	0.77	0.99	20%	1.70



© All documentation is subject to change without notice. Please refer to our website for the latest product information and specifications. Please contact us for details.

[www.lumenefficientdesign.ca](http://www.lumenefficientdesign.ca)

# CSS-UV42KITS (AM42)

# PLC/PLT/PLL Program Start Ballast Kit

## Electrical Data

Lamp Type	Lamps Operated	Line Voltage	Input Watts*	Nominal Line Amps	Ballast Factor	Power Factor	THD	Crest Factor
PLT42W		230		0.19		0.98	15%	
		277		0.16		0.97	20%	
PLC32W	1	120	31	0.26	0.88	0.99	10%	1.70
PLT32W		230		0.14		0.97	15%	
		277		0.12		0.95	20%	
PLL40W	1	120	41	0.34	0.78	0.99	10%	1.70
		230		0.18		0.98	15%	
		277		0.15		0.97	20%	
PLL39W	1	120	31	0.26	0.49	0.99	10%	1.70
		230		0.15		0.97	15%	
		277		0.12		0.96	20%	
PLL36W	1	120	33	0.27	0.73	0.99	10%	1.70
		230		0.14		0.97	15%	
		277		0.12		0.96	20%	
2D38W	1	120	31	0.26	0.65	0.99	15%	1.70
		230		0.15		0.97	15%	
		277		0.12		0.95	20%	
2D28W	1	120	30	0.26	0.67	0.99	10%	1.70
		230		0.13		0.97	15%	
		277		0.11		0.95	20%	
FC12T5	1	120	39	0.31	0.80	0.99	10%	1.70
		230		0.17		0.98	15%	
		277		0.14		0.96	20%	
FC9T5	1	120	26	0.22	0.95	0.98	15%	1.70
		230		0.12		0.97	20%	
		277		0.10		0.95	20%	
FC8T5	1	120	19	0.16	0.70	0.98	15%	1.70
		230		0.08		0.97	20%	



# CSS-UV42KITS (AM42)

# PLC/PLT/PLL Program Start Ballast Kit

## Electrical Data

Lamp Type	Lamps Operated	Line Voltage	Input Watts*	Nominal Line Amps	Ballast Factor	Power Factor	THD	Crest Factor
		277		0.07		0.95	20%	

\* ANSI measured wattage; 25°C ambient; bench top; lamps base up  
 Application and Performance Specification Information is subject to change without notification.

## Wiring Diagram

## Mechanical Data

Lead Length (Kit)	Overall Length (L)	4.92"	12.50 cm		
Black	9.00"	23.00 cm	Width (W)	2.51"	6.40 cm
White	9.00"	23.00 cm	Height (H)	1.14"	2.90 cm
Green	9.00"	23.00 cm	Mounting (M)	4.49"	11.40 cm
Red	9.00"	23.00 cm	Case Quantity	20	
Blue	9.00"	23.00 cm	Net Weight	15.65 lbs	7.10 kg
Yellow	9.00"	23.00 cm	Gross Weight	17.86 lbs	8.10 kg

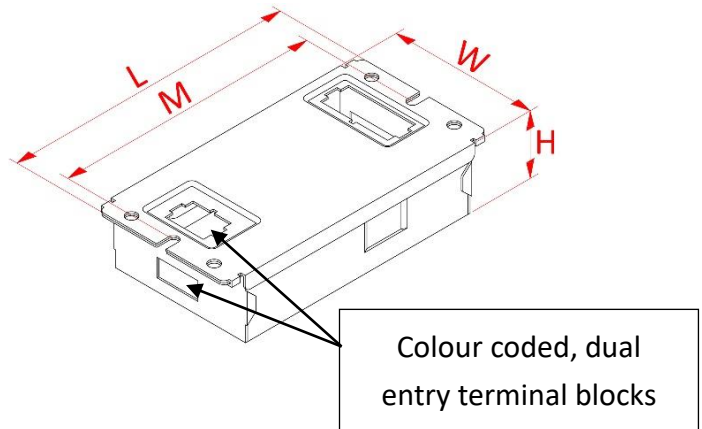
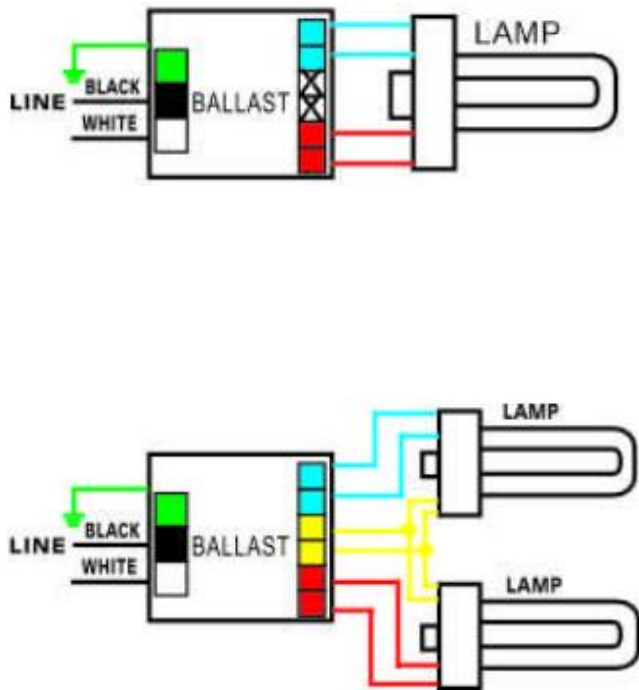

# CSS-UV42KITS (AM42)

# PLC/PLT/PLL Program Start Ballast Kit

Wiring Diagram

Mechanical Data

Mounting Plate with Studs

Extending Wire Set

Wire Extraction Tool

Hardware

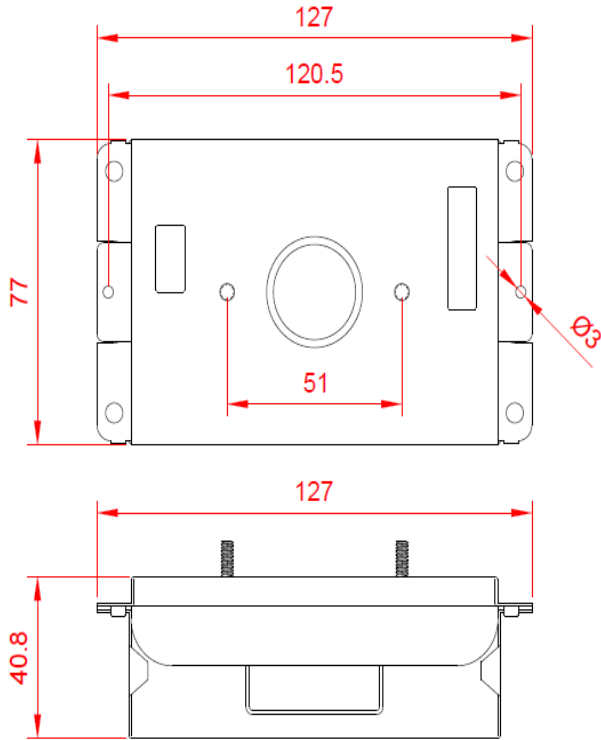

Maximum wiring distance (at full load) is 18AWG/18'  
Ballast must be grounded

Install in accordance with the National Electrical Code

